

FRP系列防水玻璃纖維開關箱

FRP Series Polyester Enclosure



Polyester Enclosure

MIP series are new type, it made by polyesters. The characteristics of the polyesters is its own min 30% fibre glass, make it reached high resistance and mechanical stiffness, have the same effect of metal enclosure which is 3 times heavier than it. Compared with metal enclosure, MIP series are lighter, more adequate for corrosion and dankish environment.

玻璃纖維箱

MIP系列是新型的開關箱，它由玻璃纖維強化多元酯所製造，達到IP65、IK9等級。多元酯的特性是它本身混合30%玻璃纖維來強化，使它達到一個高電阻和機械剛度（IK9）與重量約1/3的金屬箱的效果。同金屬箱相比，MIP系列具有重量更輕，更適應腐蝕、潮濕的環境等優點。為達IP65防水條件，建議安裝方式為直立式壁掛。

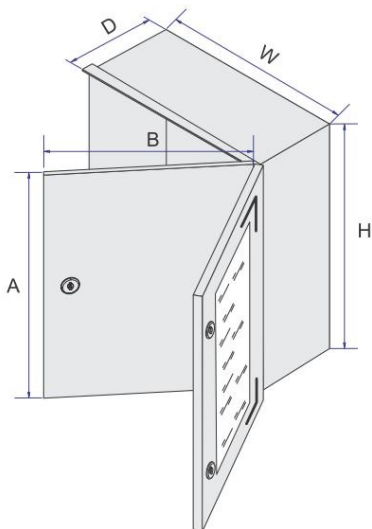

Model 型號		Dimension	
Grey Door 灰色門	Transparent Door 透明門	W	H D
MIP-325	MIP-325PT	250×300	140 單門鎖
MIP-430	MIP-43PT	300×400	200
MIP-440	MIP-44PT	400×400	200
MIP-540	MIP-54PT	400×500	200
MIP-640	MIP-64PT	400×600	230
MIP-650	MIP-65PT	500×600	230
MIP-860	MIP-86PT	600×800	300

FRP Series Polyester Enclosure

玻璃纖維底板
Polyester plate

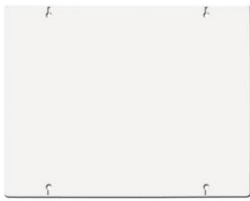

鐵底板
Mounting plate



If the C greater than 500, the floor will be bent, the table below for after bending size.

寬度大於500以上的底板會被折彎

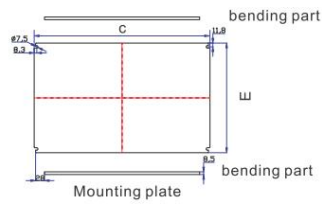
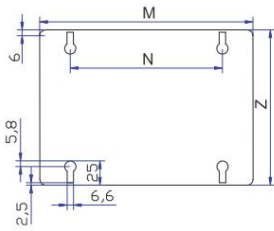

Polyester plate 玻璃纖維底板	Dimension			Mounting plate 鐵底板	Dimension	
	M	N	Z		C	E
PP-325	220	238	157	MI-325	263	201
PP-43	310	285	210	MI-43	353	245
PP-44	307	385	227	MI-44	349	345
PP-54	408	385	277	MI-54	453	345
PP-64	510	358	327	MI-64	553	345
PP-65	507	485	327	MI-65	553	447
PP-86	705	580	477	MI-86	749	540

裏門
Inner door

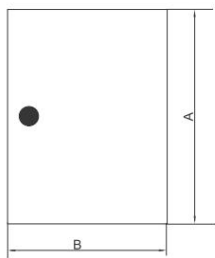

Inner door 里门	Dimension	
	A	B
MP-43	366	258
MP-44	366	358
MP-54	466	358
MP-64	566	358
MP-65	566	458
MP-86	766	658



FOR ALL MIP BOX

玻璃纖維箱的鎖和掛牆鈎